

# EXAMPLE TRAFFIC CONTROL PLAN for COMMUNITY EVENTS (Typical)

For locations that involve more than one block, a site-specific traffic control plan will be required.

Traffic Control Devices needed to close one typical block:

- 6- Type I Barricades
- 2-  or  signs: 30" x 24" min. size

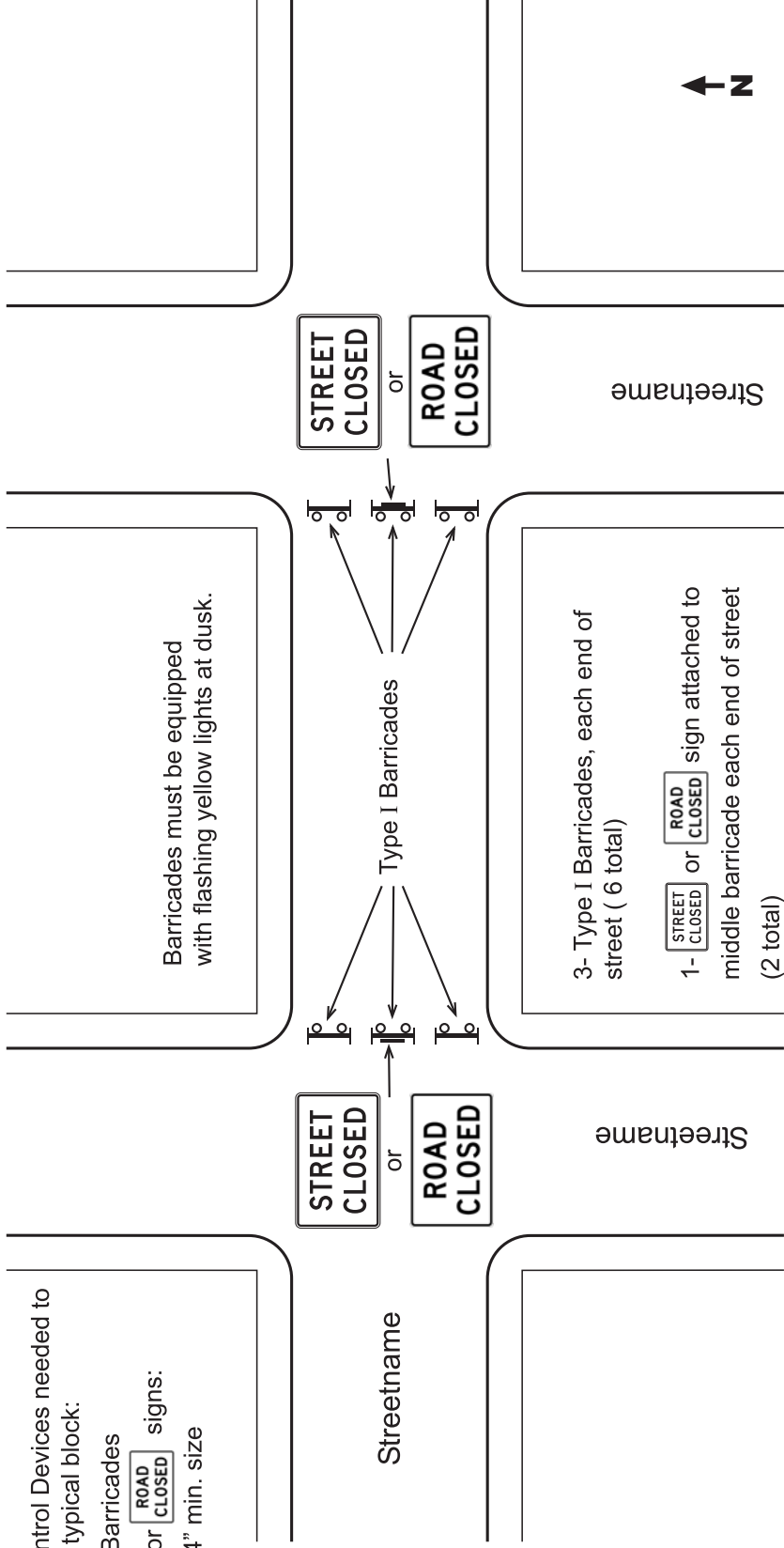

THIS EXAMPLE IS FOR A TYPICAL BLOCK CONFIGURATION.  
 IF YOUR STREET DOES NOT MEET THIS CONFIGURATION, YOU MAY BE REQUIRED TO  
 SUBMIT A TRAFFIC CONTROL PLAN WITH YOUR APPLICATION.

TRANSPORTATION SYSTEM MANAGEMENT		CITY OF PORTLAND, OREGON	
TITLE OF STANDARD PLAN		STANDARD PLAN NO.	
<b>STANDARD STREET CLOSURE TRAFFIC CONTROLS</b>		<b>4b</b>	
APPROVED	NO.	REVISIONS	DATE
CITY TRAFFIC ENGINEER			Community Events
	DATE		